

PARTS & MATERIAL LIST

ITEM	PART NAME	MATERIAL
1	Body	ASTM A105
2	Disc	ASTM A182 F6a
3	Gasket	304+graphite
4	Bonnet	ASTM A105
5	Bolt	ASTM A193 B7
6	Nameplate	AL
7	Rivet	AL
8	Spring	17-4PH
9	Welded Flanged	ASTM A105

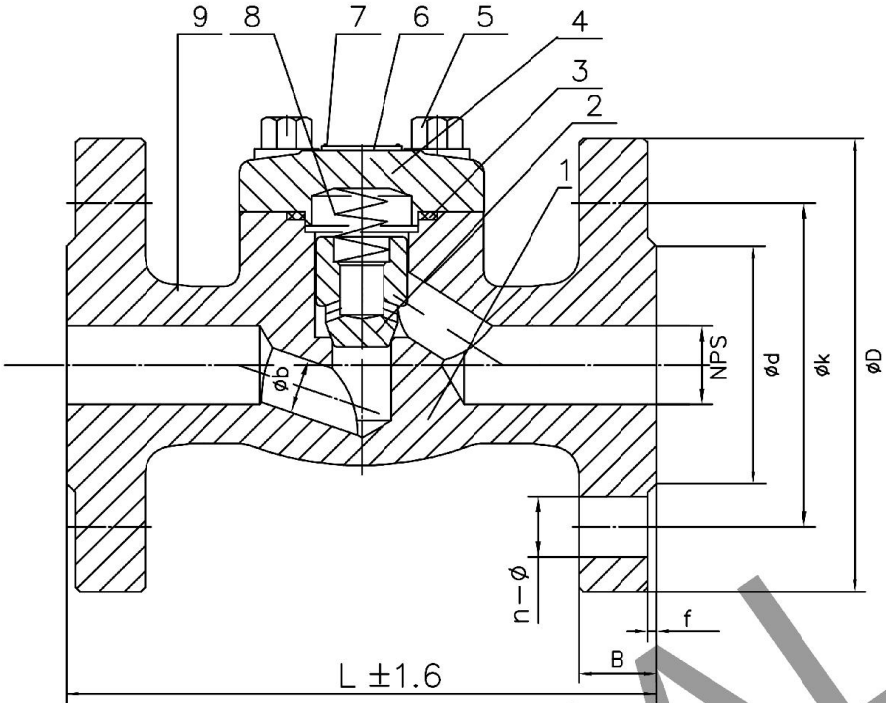

Performance		
Pressure	300	LB
Test	Shell test	8.0
	Back seal test	5.8
	Seal test	5.8
	Air test	0.6
Max temperature	425	°C
Medium:W.O.G		

- Note:
1. Design and manufacture as per BS 5352.
 2. Flange dimension as per ANSI B16.5.
 3. Face to face as per ANSI B16.10.
 4. Test as per API598.

NPS	L	ØD	ØK	Ød	B	f	Øb	n-Ø
1/2	153	95	66.5	35	14.5	1.6	10	4-Ø16
3/4	178	117	82.5	43	16	1.6	13	4-Ø20
1	203	124	89	51	17.5	1.6	17.5	4-Ø20
1 1/4	216	133	98.5	63.5	19	1.6	23	4-Ø20
1 1/2	229	156	114	73	21	1.6	30	4-Ø23
2	267	165	127	92	22.5	1.6	35	8-Ø20

Life Check Valve-300#-Reduced port			
CLIENT		DWG REV .NO	00
P.O.NO		CLASS	
APPROVED BY		HYDROSTATIC TEST (PSI)	SHELL SEAT
REVIEWED BY		AIR TSET	
MADE BY		DATE	
DRAWING NO	1/2"-2"-6928-LIFT CHECK		
GDVAL VALVE			